

Note: Apply plaster first then fascia and gutter.

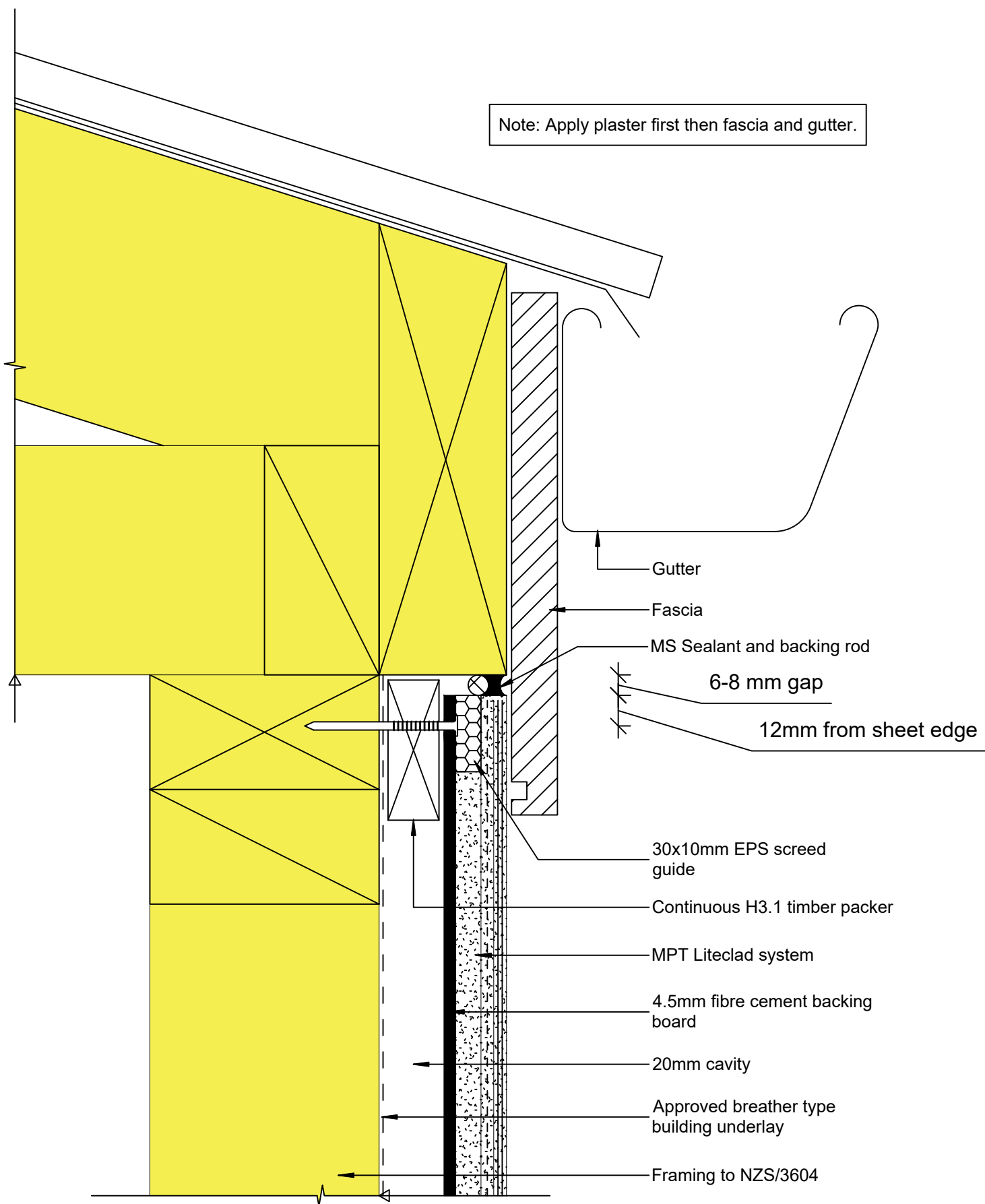

- Gutter
- Fascia
- MS Sealant and backing rod
- 6-8 mm gap
- 12mm from sheet edge
- 30x10mm EPS screed guide
- Continuous H3.1 timber packer
- MPT Liteclad system
- 4.5mm fibre cement backing board
- 20mm cavity
- Approved breather type building underlay
- Framing to NZS/3604

© 2019 Petros Holdings Ltd



Mineral Plaster
Technology

61 Hillside Rd, Wairau Valley
Auckland 0627
New Zealand
www.mineralplaster.co.nz Ph: 0800 25 23 678

MPT Liteclad System

Soffit - Flush Eaves Gutter

Reference: mpt_I074
Date: January 2020
Scale: 1 : 2 @ A4
Revision: 2

TERMS OF USE Disclaimer: This information is intended solely as a guide for use of MPT products. Before using you should ensure that the product is suitable for use in the specific application. Nothing in this information constitutes a statement of fitness for particular purpose and appropriate expert advice is to always be obtained. Petros Holdings Ltd makes no warranty regarding the use of this information. This drawing is the property of Petros Holdings Ltd. It must not be copied in any form except for the purpose of specifying the use of MPT products in construction projects.