

# MPT Stoneclad System

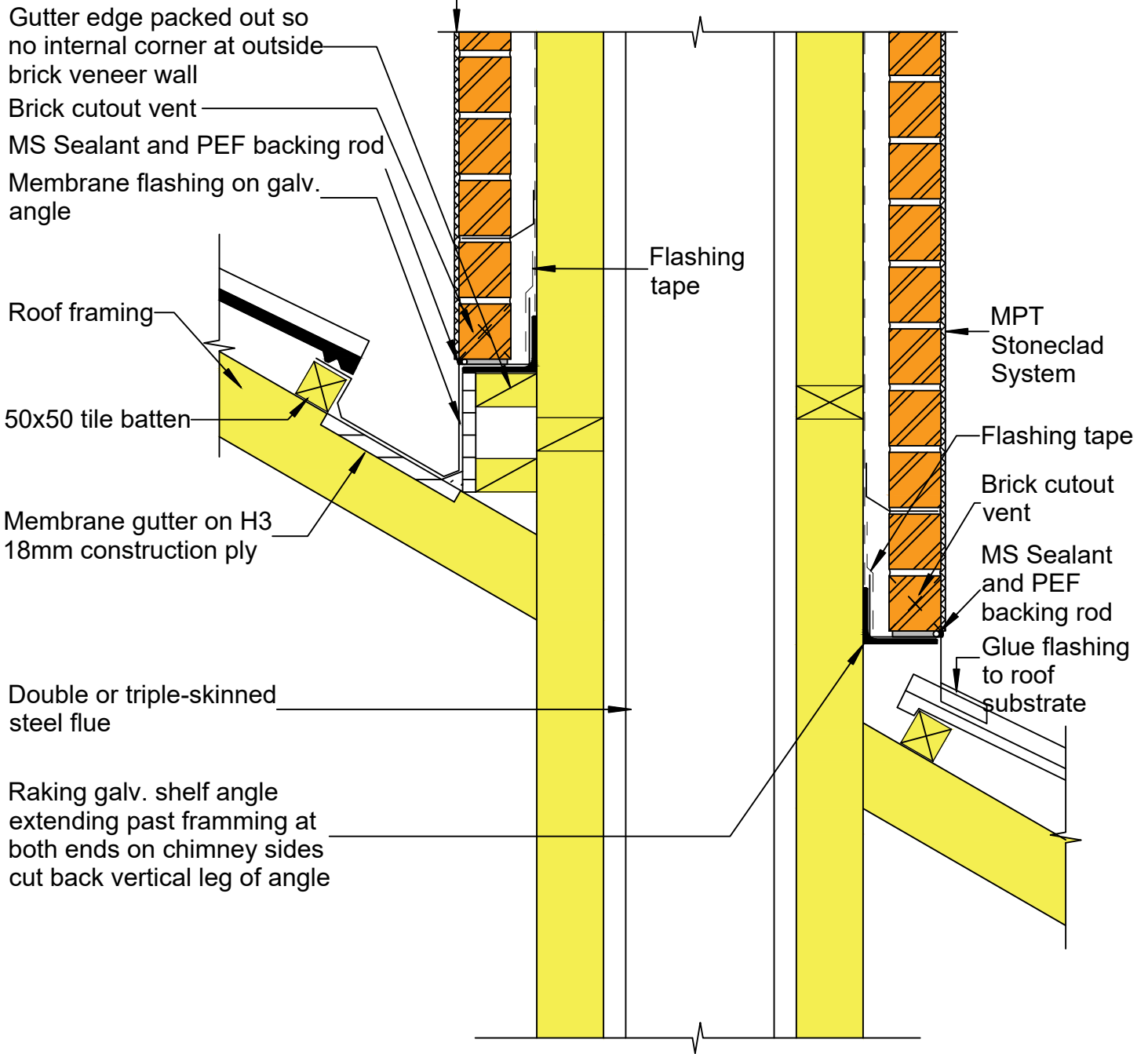

**Important Note:**  
 Mortar joints 10mm ± 3,  
 6mm max rake (Hard-tooled  
 concave joint preferred)

© 2019 Petros Holdings Ltd



**Mineral  
Plaster**  
Technology

61 Hillside Rd, Wairau Valley  
 Auckland 0627  
 New Zealand  
 www.mineralplaster.co.nz

Ph: 0800 25 23 678

## MPT Stoneclad System Chimney Detail

Reference: MPT\_S026

Date: September 2019

Scale: 1 : 8 @ A4

Revision: 2

TERMS OF USE Disclaimer: This information is intended solely as a guide for use of MPT products. Before using you should ensure that the product is suitable for use in the specific application. Nothing in this information constitutes a statement of fitness for particular purpose and appropriate expert advice is to always be obtained. Petros Holdings Ltd makes no warranty regarding the use of this information. This drawing is the property of Petros Holdings Ltd. It must not be copied in any form except for the purpose of specifying the use of MPT products in construction projects.